



# DMD 341

## Differential Pressure Transmitter for Gases and Compressed Air in Compact Version

Silicon Sensor

accuracy according to EN IEC 62828-2:  
0.35 % / 1% / 2%

### Differential pressure

from 0 ... 6 mbar up to 0 ... 1000 mbar

### Output signals

2-wire: 4 ... 20 mA

3-wire: 0 ... 20 mA / 0 ... 10 V

### Special characteristics

- ▶ aluminium housing
- ▶ suited for non-aggressive gases and compressed air



### Optional versions

- ▶ customer specific versions

The DMD 341 is a differential pressure transmitter for non-aggressive gases and compressed air. Because of its compact and robust aluminium housing it is particularly suited for machine and plant engineering.

Basic element of the DMD 341 is a piezoresistive stainless steel silicon sensor, which features high accuracy and excellent long term stability.

### Preferred areas of use are

-  Plant and Machine Engineering
-  Heating and Air Conditioning

### Preferred used for

-  Compressed Air,  
Non-Aggressive Gases

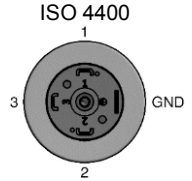
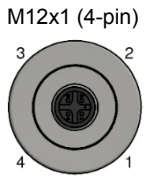

Input pressure range												
Nominal pressure $P_N$ (over, differential pressure) [mbar]	0...6	0...10	0...20	0...40	0...60	0...100	0...160	0...250	0...400	0...600	0...1000	
Nominal pressure $P_N$ symmetric (differential pressure) [mbar]	± 6	± 10	± 20	± 40	± 60	± 100	± 160	± 250	± 400	± 600	± 1000	
Overpressure [mbar]	100	100	200	350	350	1000	1000	1000	1000	3000	3000	
Output signal / Supply												
Standard	standard pressure range: 2-wire: 4 ... 20 mA / $V_S = 8 \dots 32 V_{DC}$											
Options 3-wire	standard pressure range: 3-wire: 0 ... 20 mA / $V_S = 14 \dots 30 V_{DC}$ 0 ... 10 V / $V_S = 14 \dots 30 V_{DC}$											
Performance												
Accuracy <sup>1</sup>	$P_N > 160$ mbar: $\leq \pm 0.35$ % span $40 \text{ mbar} \leq P_N \leq 160$ mbar: $\leq \pm 1$ % span $P_N < 40$ mbar: $\leq \pm 2$ % span											
Permissible load	current 2-wire: $R_{max} = [(V_S - V_S \text{ min}) / 0.02 \text{ A}] \Omega$ current 3-wire: $R_{max} = 500 \Omega$ voltage 3-wire: $R_{min} = 10 \text{ k}\Omega$											
Influence effects	supply: 0.05 % span / 10 V load: 0.05 % span / $\text{k}\Omega$											
Long term stability	$\leq \pm 0.2$ % span / year at reference conditions											
Response time	< 5 msec											
<sup>1</sup> accuracy according to EN IEC 62828-2 – limit point adjustment (non-linearity, hysteresis, repeatability)												
Thermal effects (Offset and Span) / Permissible temperatures												
Nominal pressure $P_N$ [mbar]	$\leq 10$			$\leq 20$			$\leq 250$			> 250		
Tolerance band [% span]	$\leq \pm 2$			$\leq \pm 1.5$			$\leq \pm 1$			$\leq \pm 0.5$		
TC, average [% span / 10 K]	$\pm 0.3$			$\pm 0.25$			$\pm 0.15$			$\pm 0.08$		
in compensated range	0 ... 60 °C											
Permissible temperatures	medium: -25 ... 125 °C			electronics / environment: -25 ... 85 °C			storage: -40 ... 100 °C					
Electrical protection												
Short-circuit protection	permanent											
Reverse polarity protection	no damage, but also no function											
Electromagnetic compatibility	emission and immunity according to EN 61326											
Mechanical stability												
Vibration	10 g RMS (20 ... 2000 Hz)											
Shock	100 g / 11 msec											
Materials												
Pressure port	G1/8" internal: aluminium, silver anodized flexible tube connection $\text{Ø}6.6 \times 11$ : brass, nickel plated											
Housing	aluminium, silver anodised											
Seal (media wetted)	PUR, bonded											
Sensor	silicon, glass, RTV, ceramics $\text{Al}_2\text{O}_3$ , nickel											
Media wetted parts	pressure port, housing, seal, sensor											
Miscellaneous												
Connecting cables (by factory)	cable capacitance: signal line/shield also signal line/signal line: 160 pF/m cable inductance: signal line/shield also signal line/signal line: 1 $\mu\text{H}/\text{m}$											
Current consumption	signal output current: max. 25 mA signal output voltage: max. 7 mA											
Weight	approx. 250 g											
Operational life	> 100 x 10 <sup>6</sup> pressure cycles											
CE-conformity	EMC Directive: 2014/30/EU											
Pin configuration												
Electrical connection							cable colours (IEC 60757)					
	Supply +	1	1	white								
Supply -	2	2	brown									
Signal + (only 3-wire)	3	3	green									
Shield	ground pin	4	yellow / green									

### Wiring diagrams

#### 2-wire-system (current)

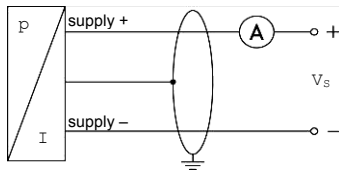

#### 3-wire-system (current / voltage)

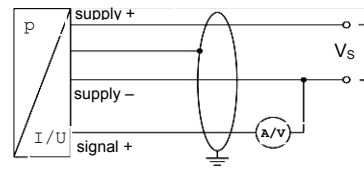

### Electrical connections (dimensions in mm)

#### standard

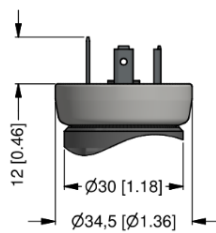

ISO 4400 (IP 65)

#### option

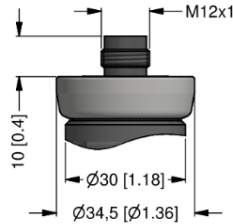

M12x1 4-pin (IP 67)

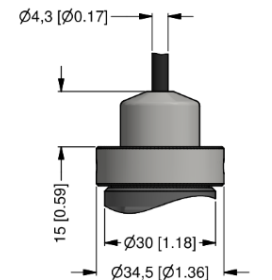

Cable outlet with PVC-cable (IP 67)<sup>2</sup>

<sup>2</sup> standard: 2 m PVC cable (without ventilation tube), optionally cable with ventilation tube

### Dimensions (dimensions in mm)

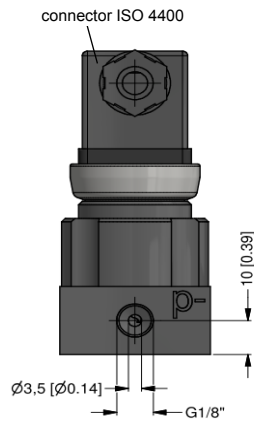
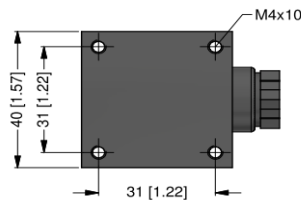

connector ISO 4400

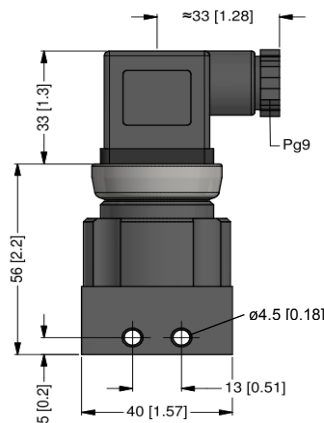

G1/8" internal

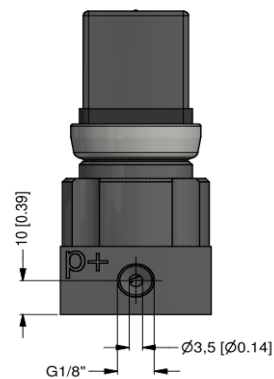

### Mechanical connection (dimensions in mm)

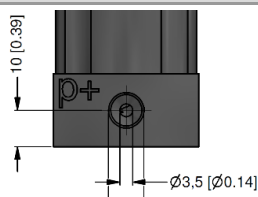

G1/8" internal thread

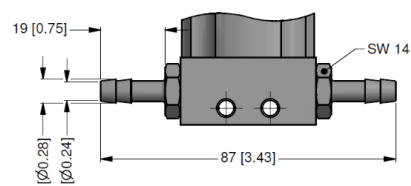

Ø6.6x11 (for flex. tubes Ø6)

This data sheet contains product specification. properties are not guaranteed. Subject to change without notice.

## Ordering code DMD 341

9.12.2020

DMD 341

--	--	--	--	--	--	--	--	--	--	--	--	--	--	--	--	--	--	--	--

Pressure																					
Differential	3	3	0																		
Gauge	3	3	1																		
Input [mbar]																					
0 ... 6 mbar				0	0	6	0														
0 ... 10 mbar				0	1	0	0														
0 ... 20 mbar				0	2	0	0														
0 ... 40 mbar				0	4	0	0														
0 ... 60 mbar				0	6	0	0														
0 ... 100 mbar				1	0	0	0														
0 ... 160 mbar				1	6	0	0														
0 ... 250 mbar				2	5	0	0														
0 ... 400 mbar				4	0	0	0														
0 ... 600 mbar				6	0	0	0														
0 ... 1000 mbar				1	0	0	1														
-6 ... 6 mbar				S	0	0	6														
-10 ... 10 mbar				S	0	1	0														
-20 ... 20 mbar				S	0	2	0														
-40 ... 40 mbar				S	0	4	0														
-60 ... 60 mbar				S	0	6	0														
-100 ... 100 mbar				S	1	0	0														
-160 ... 160 mbar				S	1	6	0														
-250 ... 250 mbar				S	2	5	0														
-400 ... 400 mbar				S	4	0	0														
-600 ... 600 mbar				S	6	0	0														
-1000 ... 1000 mbar				S	1	0	2														
Customer range				9	9	9	9														
Customer underpressure				X	X	X	X														
Output																					
4 ... 20 mA / 2-wire																			1		
0 ... 20 mA / 3-wire																			2		
0 ... 10 V / 3-wire																			3		
Customer																			9		
Accuracy																					
0,35 % (P <sub>N</sub> > 160 mbar)																			3		
1 % (P <sub>N</sub> = 40 ... 160 mbar)																			8		
2 % (P <sub>N</sub> < 40 mbar)																			G		
0,35 % including Calibration Certificate (P <sub>N</sub> > 160 mbar)																			S		
1 % including Calibration Certificate (P <sub>N</sub> = 40 ... 160 mbar)																			U		
2 % including Calibration Certificate (P <sub>N</sub> < 40 mbar)																			L		
Customer																			9		
Electrical connection																					
Connector DIN 43650 (ISO 4400) (IP 65)																			1	0	0
Connector M12 x 1, 4-pin (IP 67)																			M	0	0
Connector M12 x 1, 4-pin (IP 67) - metal																			M	1	0
Cable outlet with PVC cable (cable length needs to specified) (IP 67) <sup>1</sup>																			T	A	0
+ PVC cable / 1 m																					
Customer																			9	9	9



BD SENSORS s.r.o.  
Hradištská 817  
CZ – 687 08 Buchlovice

Tel.: +420 572 411 011  
Fax: +420 572 411 497

www.bdsensors.cz  
info@bdsensors.cz



The company BD SENSORS s.r.o. is certified by TÜV SÜD Czech according to the standard ISO 9001.

Mechanical connection									
G 1/8" internal thread	Q	0	0						
Ø 6,6 x 11 (for tubes Ø 6)	Y	0	0						
Customer	9	0	0						
Seals									
PUR							6		
Special version									
Standard								0	0
Customer								9	9

0,-...without additional charge

On request... in accordance with the producer

1 - cable without through capillary (permissible temperature -5 ... +70°C)

Surcharges for calibration are not subject to any discounts. Subject to change. □

This document contains the specification for ordering the product;

detailed technical parameters of the product and its possible variants are given in the data sheet.

BD SENSORS reserves the right to change sensor specifications without further notice.



BD SENSORS s.r.o.  
Hradištská 817  
CZ – 687 08 Buchlovice

Tel.: +420 572 411 011  
Fax: +420 572 411 497

www.bdsensors.cz  
info@bdsensors.cz

The company BD SENSORS s.r.o. is certified by TÜV SÜD Czech according to the standard ISO 9001.

